

ESAB®/L-TEC® PT-36™

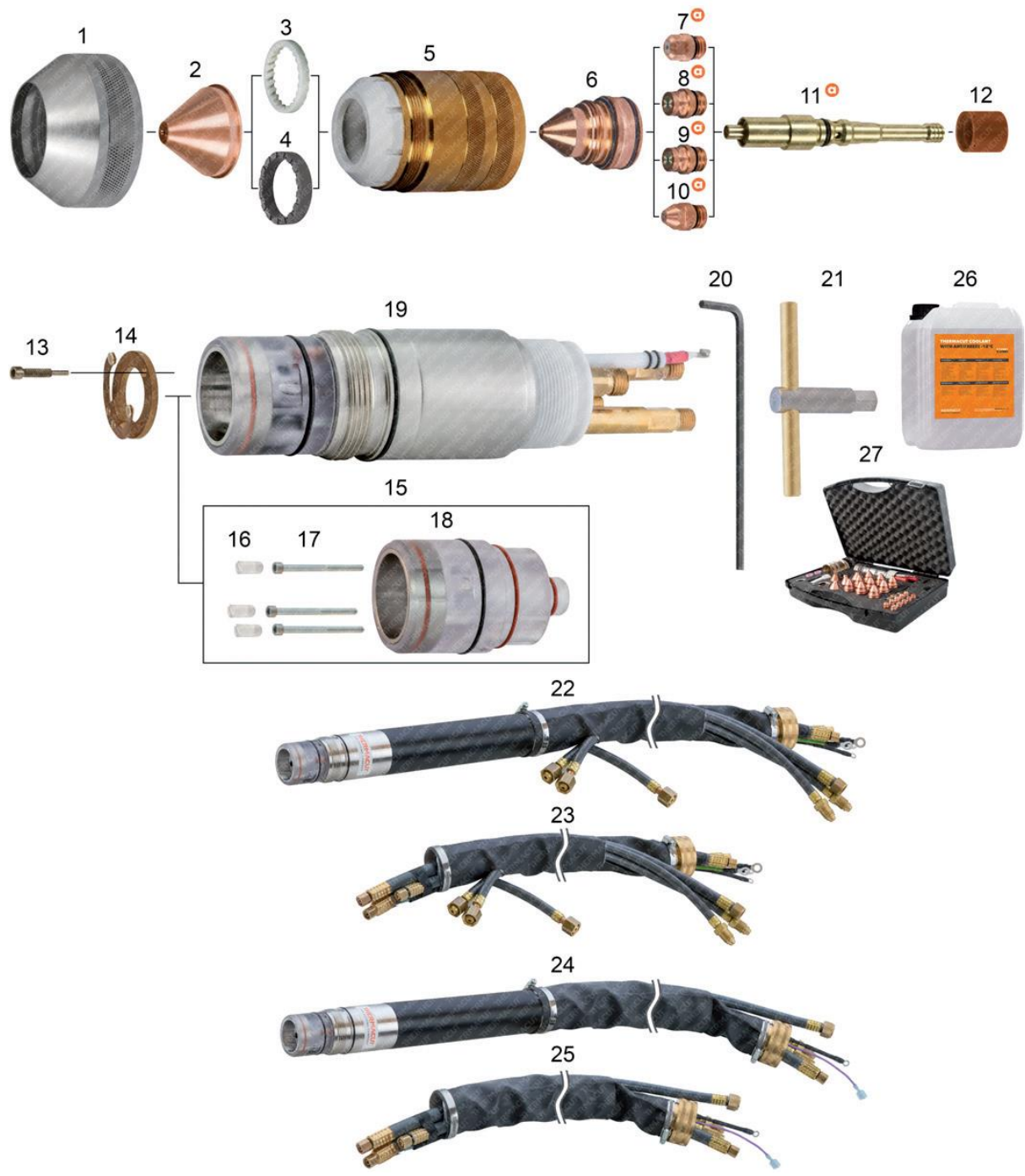

Item	Part No.	Ref. No.	Description	Std. Pkg.	Item	Part No.	Ref. No.	Description	Std. Pkg.
1.	T-10128	37081	Shield Retainer	1	14.	T-11863	0558003858	Cont. Ring with 2pcs Screws 37073(=37071)	1
2.	T-10463	0558007624	Shield Cup 2,4mm 45-55A	1	15.	T-12040	T-12040	Exchangeable insulator kit	1
	T-10333	0558006130	Shield Cup 3,0mm 35-50A	1	16.	PT-13160	0558001825-11	Plastic screw	1
	T-10332	0558006141	Shield Cup 4,1mm 70-280A	1	17.	PT-13159	0558001825-10	Screw	1
	T-10334	0558006166	Shield Cup 6,6mm 290-450A	1	18.	PT-12123	0558001825-8	Insulator body	1
	T-10335	0558006199	Shield Cup 9,9mm 300-600A	1	19.	T-11208	0558003804	Torch Body PT-36™	1
3.	T-2269	21944	Shield Gas Diffuser, Standard	1	20.	N-20426	93750010	Hex Key Wrench for Contact Ring	1
	T-10331	22496	Shield Gas Diffuser 100-360A, CCW	1	21.	T-11665	0558003918 OEM	Electrode Holder Wrench	1
4.	T-2268	21796	Gas Diffuser 50A	1	22.	KT-1452	0558006745	PT36™ Mach. torch with Leads 1,3m	1
5.	T-10129	37082	Nozzle Retaining Cap, Standard	1		KT-1453	0558006746	PT36™ Mach. torch with Leads 1,8m	1
6.	T-10336	0558006010	Nozzle 1,0mm 45/50A MS/SS/AL	1		KT-1454	0558006747	PT36™ Mach. torch with Leads 3,7m	1
	T-10337	0558006014	Nozzle 1,4mm 100A MS/AL, 70/130A SS	1		KT-1455	0558006749	PT36™ Mach. torch with Leads 4,6m	1
	T-10970	0558006018	Nozzle 1,8mm 100/130A MS, 100A SS/AL	1		KT-1456	0558006750	PT36™ Mach. torch with Leads 5,2m	1
	T-10338	0558006020	Nozzle 2,0mm 150/200A MS/AL, 130/150A SS	1		KT-1457	0558006779	PT36™ Mach. torch with Leads 6,1m	1
	T-10339	0558006023	Nozzle 2,3mm 200/280A MS, 200A SS, 200/260A AL	1		KT-1458	0558006751	PT36™ Mach. torch with Leads 7,6m	1
	T-10340	0558006025	Nozzle 2,5mm 280/290A MS, 260A SS	1	23.	KT-1460	0558007031	PT-36™ Cable Leads 1,3m	1
	T-10443	0558006030	Nozzle 3,0mm 325/360A MS, 360A SS/AL	1		KT-1461	0558007032	PT-36™ Cable Leads 1,8m	1
	T-10341	0558006036	Nozzle 3,6mm 400A MS, 450A SS	1		KT-1462	0558007034	PT-36™ Cable Leads 3,7m	1
	T-10292	0558006041	Nozzle 4,1mm 600A SS/AL	1		KT-1463	0558007036	PT-36™ Cable Leads 4,6m	1
7.	T-11303	T-11303-PRO	Electrode 50-250A, Silver PRO	5		KT-1464	0558007037	PT-36™ Cable Leads 5,2m	1
8.	T-11290*	0558003914-PRO	Electrode 100-400A, O ₂ , Silver PRO	5		KT-1465	0558007038	PT-36™ Cable Leads 6,1m	1
9.	T-11994	0558012000-PRO	Electrode, O ₂	5		KT-1466	0558007039	PT-36™ Cable Leads 7,6m	1
10.	T-11910	0558003928-UR	Electrode, N ₂ /H ₃₅	5	24.		0558003849	PT36™ Mach. torch with Leads 1,4m	1
	T-10439	0558005459 OEM	Replaced by 0558003914-PRO	3			0558003850	PT36™ Mach. torch with Leads 1,8m	1
11.	T-11319	0558003924-UR	Electrode Holder	1			0558003852	PT36™ Mach. torch with Leads 3,7m	1
12.	T-10693	0558005457 OEM	Gas Swirl Baffle, 4 x 0,022, 35-70A	1			0558003853	PT36™ Mach. torch with Leads 4,6m	1
	T-4607	0558002534	Gas Swirl Baffle, 4 x 0,032, 100-280A, CCW	1			0558003854	PT36™ Mach. torch with Leads 5,2m	1
	T-4606	0558002533	Gas Swirl Baffle, 4 x 0,032, 100-280A	1			0558006751	PT36™ Mach. torch with Leads 7,6m	1
	T-4636	0558001625	Gas Swirl Baffle, 8 x 0,047, 300-600A	1	25.	Cable Leads are available on request, because of more possible types of fittings.			
	T-11119	0558002530	Baffle, 8 x 0,047, 360-450A, CCW	1	26.	Coolant Liquid. Details on the page 152, section Accessories.			
13.	T-11942	37073	Screw, contact ring	1	27.	Consumable Case. Details on the page 158, section Accessories.			